

EHPWH Element Heater

REPLACEMENT INSTRUCTIONS

Kit Name	Element Heater
Kit Part Number	105002064
Compatible Rinnai Products	Rinnai Heat Pump Water Heater: All REHP Series Models

WARNING Failure to correctly assemble the components according to these instructions may result in electric shock, injury, or death.

CAUTION

To protect yourself from harm, follow the steps below before proceeding.

- Antistatic gloves must be worn.
- Disconnect the electrical power supply by turning off the electricity at the circuit breaker.
- Turn off the water by closing manual ball valves for the hot and cold water connections at the appliance.

Items Inside Product Box

Before installation, please make sure all parts are located inside the product box.

Table 1

Item #	Item	Qty
1	Element Heater	1

TOOLS/MATERIALS REQUIRED

- Phillips Head Screw Driver
- 1-1/2 inch Socket Wrench

Figure 1

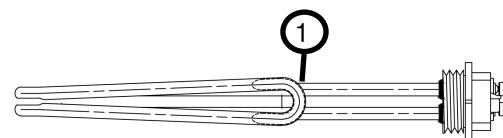

Instructions

1. Antistatic gloves must be worn to protect yourself from harm.
2. Disconnect the electrical power supply by turning off the electricity at the circuit breaker.
3. Turn off the water by closing manual valves for the hot and cold water connections at the appliance.
4. Use a Phillips head screw driver to remove 6 screws located on the cover (TCO)/ cover (electric heater) (Figure 2). Keep the removed cover safe to be reinstalled in step 11.
5. Use a Phillips head screw driver to remove a screw securing black insulation cover to gain access of element heater (Figure 3). Keep the cover safe to be reinstalled in step 10.

IMPORTANT

This appliance has two element heaters located on the front side of it. One located on the right side of hot water connection and second located above drain valve. Follow this instruction to replace either one of the element heaters. The product box includes only one element heater. If both element heaters need to be replaced, order 2 quantities.

Figure 2

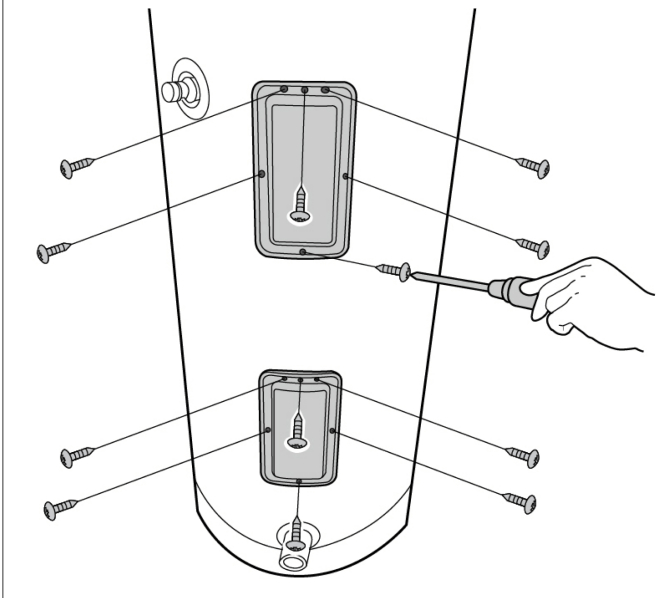
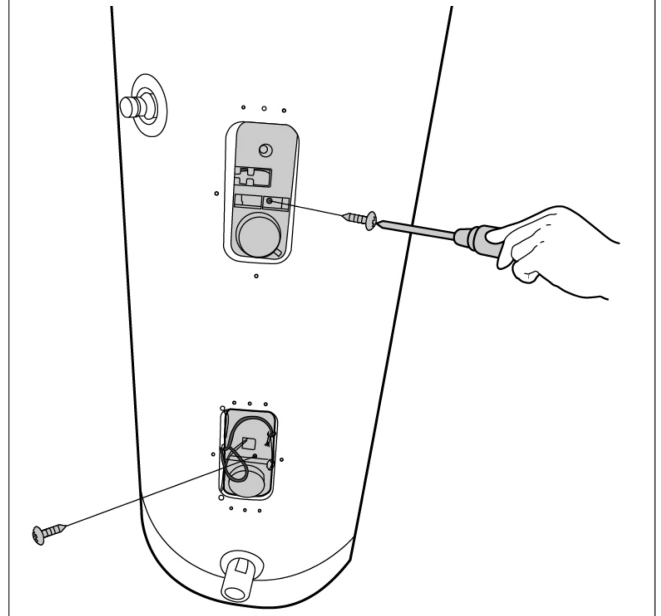

Figure 3



6. Use a Phillips head screw driver to remove 2 screws securing the ring terminal to the element heater (Figure 4). Keep removed 2 screws secured to be reinstalled in step 9.
7. Use a 1-1/2 inch socket wrench to remove the heater element (Figure 5).

CAUTION

DO NOT try to remove the element heater by rotating the element heater body. Must use 1-1/2 inch socket to hold metal hex of the element and remove.

Figure 4

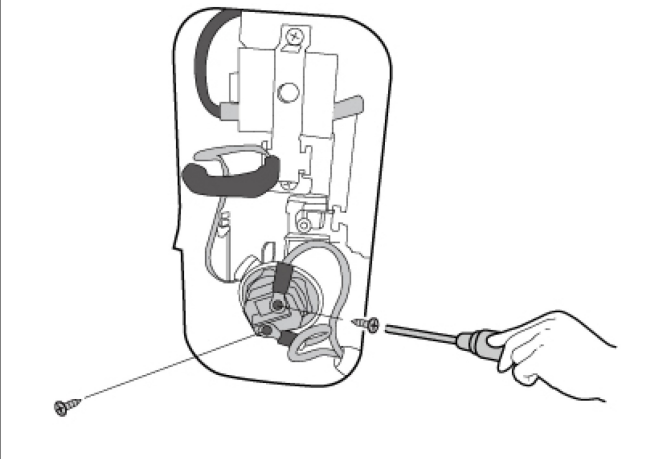
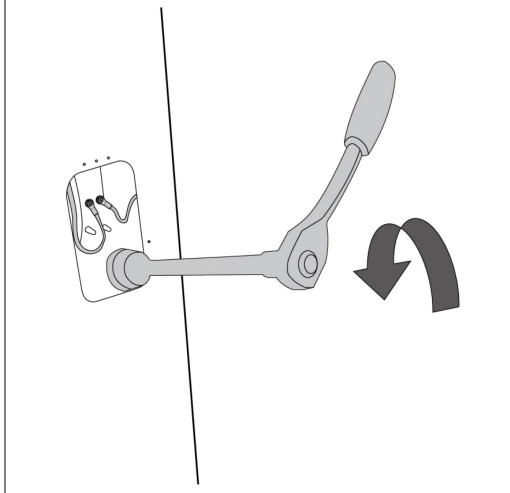

Figure 5



Element Heater Reassembly

8. Install new element heater using 1-1/2 inch socket wrench (Figure 5).
9. Reinstall 2 screws to secure ring terminals on new element heater (Figure 4).
10. Install back the back insulation cover using 2 screws (Figure 3).
11. Reinstall the cover (TCO)/ cover (electric heater) using 6 screws on the appliance (Figure 2).
12. Turn on the water by opening manual valves for the hot and cold water connections at the appliance.
13. Reconnect the electrical power supply by turning on the electricity at the circuit breaker.
14. Ensure that the appliance runs fine. May need to open one of the faucets in the house to fire up the appliance.